

# CROSS TREK



## THE LATEST INNOVATION IN CLASS C MOTORHOMES. THE ECO-FRIENDLY CROSS TREK.

CROSS TREK'S SIZE AND CAPABILITIES GIVE YOU NEARLY ENDLESS POSSIBILITIES. WITH UNRIVALED EXTERIOR STORAGE, YOU CAN OUTFIT YOUR CROSS TREK WITH THE GEAR AND EQUIPMENT NEEDED TO CONQUER ANY EXPEDITION!



### CROSS TREK XL



22XG



23XG



## XL TOP FEATURES

- Incredible Storage on all Floorplans
- Shorter Cabover Bunk  
Increases curb appeal and improves vision for driver and passenger
- Up to 380W worth of Solar Panels (optional)
- Exterior Entertainment Center (optional)
- Modern Décor and Content
- Increased Towing Capacities
- Up to 7,500 lb. Hitch (with E450 floorplans)
- 2-Inch Sidewalls with Azdel Composite



# CROSS TREK **TRANSIT**



## TRANSIT TOP FEATURES

- Ford Transit 3.5L V6 Eco-boost
- Livable and Storage Friendly Floorplans
- Larger Kitchen and Bathroom Facilities Compared to Class B Vans
- 2-Inch Sidewalls with Azdel Composite
- Molded Fiberglass Front Cap and Wing Wall
- Up to 380W worth of Solar Panels (optional)
- State-of-the-Art Electrical System  
Designed to operate every coach function from battery power, including A/C. Convenient for operating systems while traveling without the use of a generator

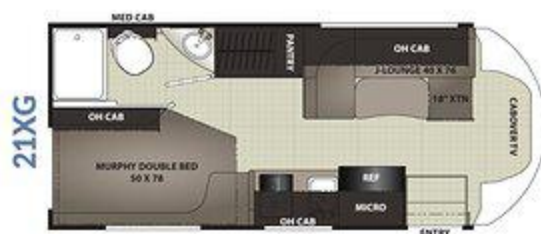

### CUSTOMER SATISFACTION



[www.ForestRiverBuyLocal.com](http://www.ForestRiverBuyLocal.com)



Coachmen RV, a Division of Forest River, Inc.,  
A Berkshire Hathaway Company

423 N. Main St., P.O. Box 30, Middlebury, IN 46540

To learn more about Coachmen RV and our products and see how Coachmen is making the easy life easier, visit [www.coachmenrv.com](http://www.coachmenrv.com)

©Copyright 2021 Coachmen RV a Division of Forest River Inc. - All Rights Reserved.



Learn More  
Scan this barcode using  
a QR Reader on your  
smart phone to learn  
more about Forest River.



A Berkshire Hathaway company.